

Fireplace Measuring Guide

Please use our convenient guide, designed to help you measure your new fireplace. Whilst other measurements will be required at a later date these will help us put together a quotation for you.

How does it work?

Simply record each of the specific values on the sheet and enter them into our handy online quote form. If you have a picture or image of a design that you have in mind you can also attach this to your submission with your measurements using the browse button.

That's it all done! We will review your information and contact you with a quotation. All our fireplaces are made to order and each will be specifically made to your measurements and chosen design.

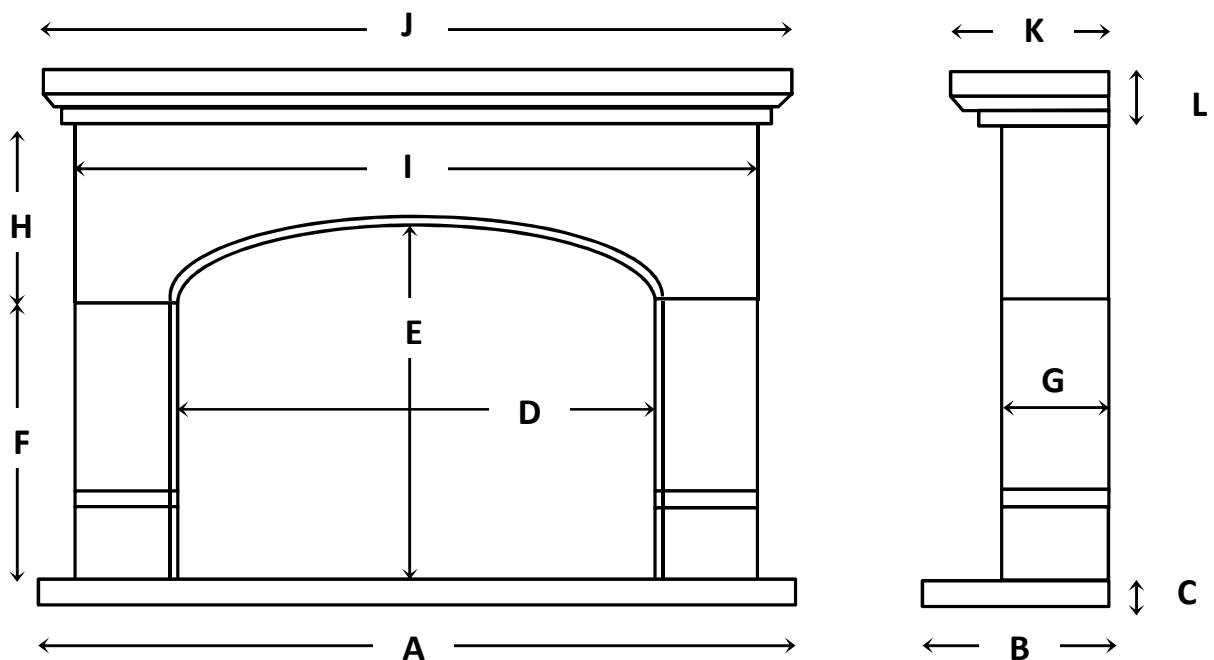

- A Hearth Length = _____mm
- B Hearth Width = _____mm
- C Hearth Height = _____mm
- D Fireplace Opening Length = _____mm
- E Fireplace Opening Height = _____mm
- F Jamb Height = _____mm
- G Jamb Width = _____mm
- H Head Height = _____mm
- I Overall Fireplace Width = _____mm
- J Mantle Length = _____mm
- K Mantle Width = _____mm
- L Mantle Height = _____mm

The colour and texture of natural stone varies due to its geological composition. Samples provided are only able to reflect the properties of a particular stone and as a result are non-binding on any purchase or materials supplied.

Go to <http://www.syreford-cotswold-stone.com/cotsfires.html> to send us your details